

# BILTMOR 5001 WITH CLASSIC LADDER 6003

## Contents of the ladder box SKU # 6003

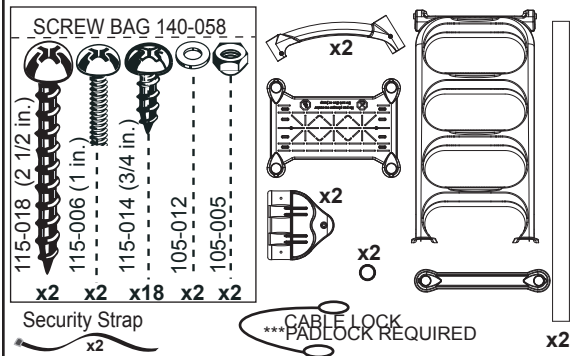

## Contents of the Biltmor box SKU # 5001

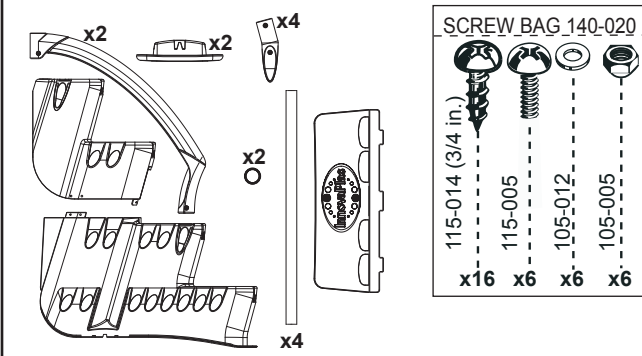

## Sand (not included)

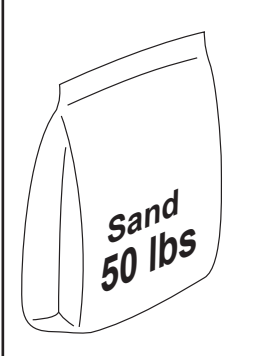

## ! WARNING

- ◆ Do not dive or jump from step or ladder.
- ◆ Use BATTERY operated tools to avoid electric shocks.
- ◆ Install step on flat surface, following the manufacturers instructions.
- ◆ Remove step from pool during freezing climate season.
- ◆ Manufacturer cannot be held responsible for injuries caused by abusive use of product.
- ◆ Ask your city about specific regulations that apply to your above-ground pool and ladder.

## Required tools and supplies (not included)

A weather resistant padlock is recommended.

Maximum functional width is 1/4 inch.

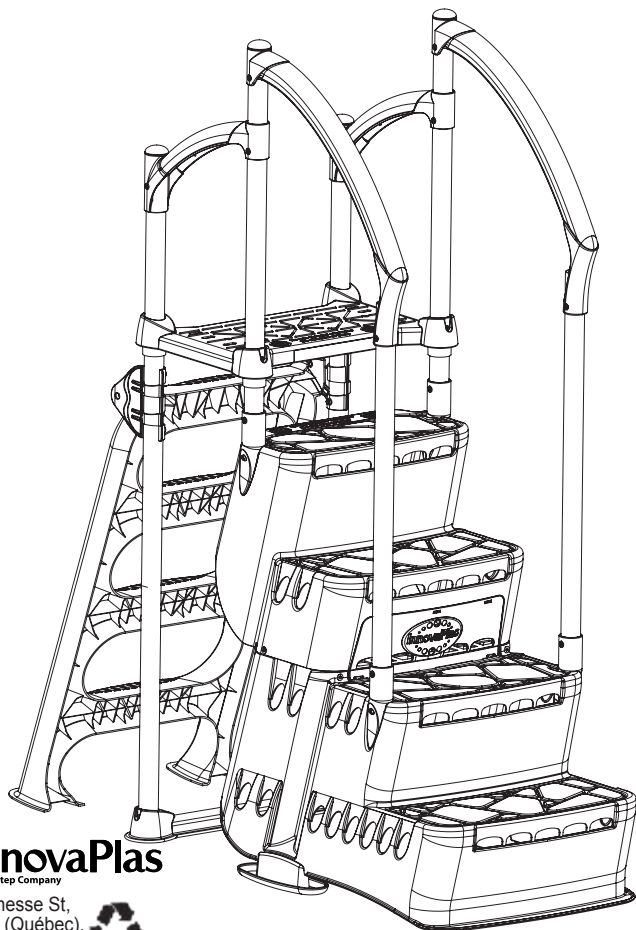
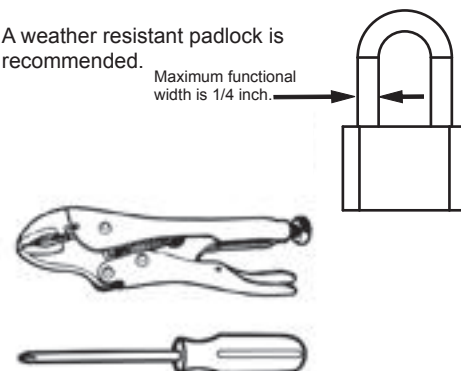

## A

- 1) Assemble the two main modules with the six screws, nuts and washers provided.
- 2) Snap the door between the top and bottom modules within the slots provided.

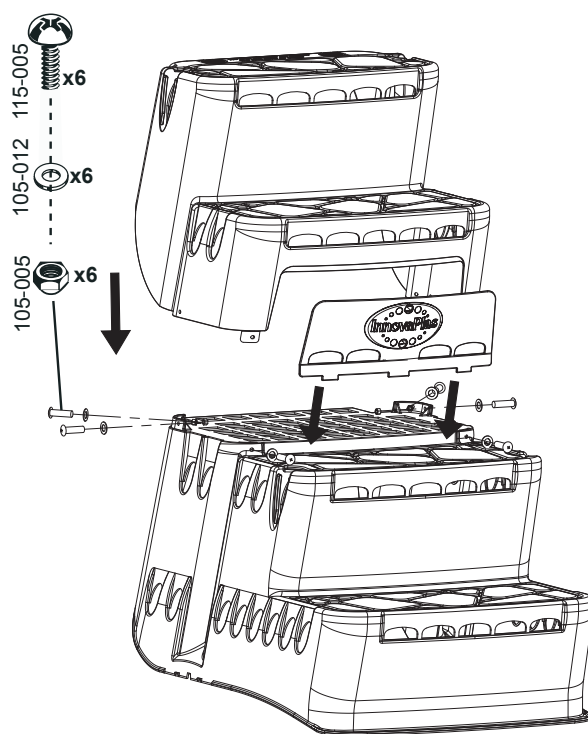

# B

1) Snap the four post ends into the step making sure that the cylindrical part is vertical and that the ends are placed and fitted properly in their respective housings.

2) Snap the 2 feet to the bottom of the step.

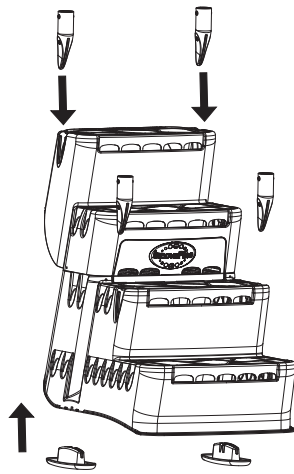

# C

1) Insert the four posts into the post ends and secure them in place with the screws provided.

2) Insert the platform over the 2 rear posts.

3) Insert the small and large handrails as illustrated. Secure the large handrails with the screws provided. Leave the small handrails floating.

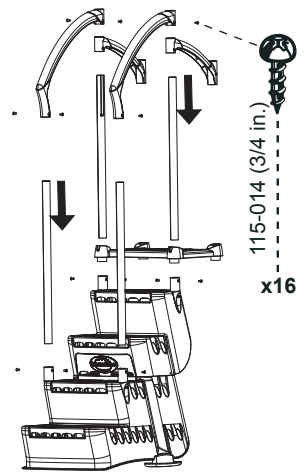

# D

1) Install the four post covers.

2) Insert a bag of sand onto surface provided at the rear of the step.

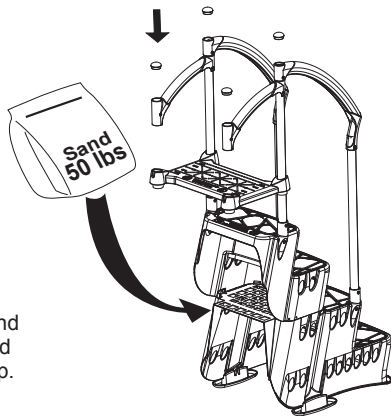

# E

1) Slowly submerge the Step in the pool. Make sure you do not damage the liner in the process.

2) Once the step is in the pool secure the platform to the top seat (see illustration) using the two straps provided.

Security strap x2

### OPTIONAL:

Once the pool step has been completely assembled and secured to the pool, attach the 2 screws supplied through the platform to the top seat of your pool to provided a more rigid assembly.

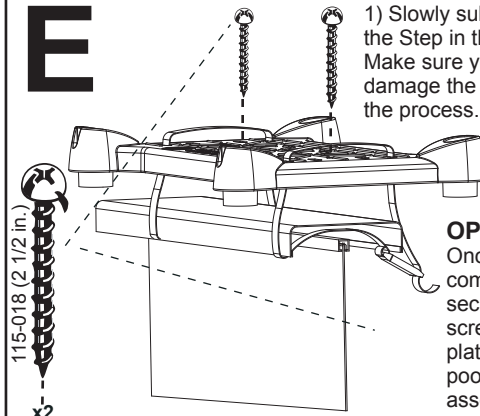

# F

- 1) Trace a line on each post at 39 inches from the ground for 48" & 52" Pools. If you have a 54" pool trace a line at 40.5" from the ground.
- 2) Slide the pivot blocks onto the posts and line up with the traced marks. Secure with the screws provided.
- 3) Slide the 2 posts through the platform and handrails.
- 4) Secure the handrails and platform to the posts with the screws provided.
- 5) Secure the ladder base to the post with the screws provided.

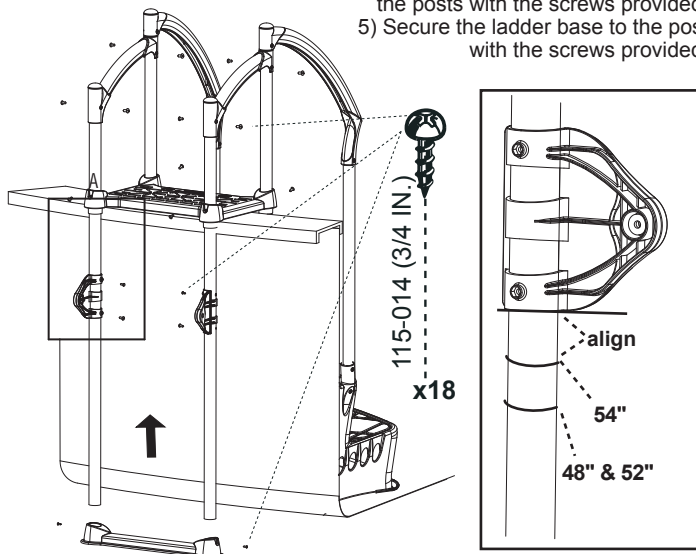

# G

2) Secure the ladder to the pivot blocks using the bolts, washers and nuts provided.

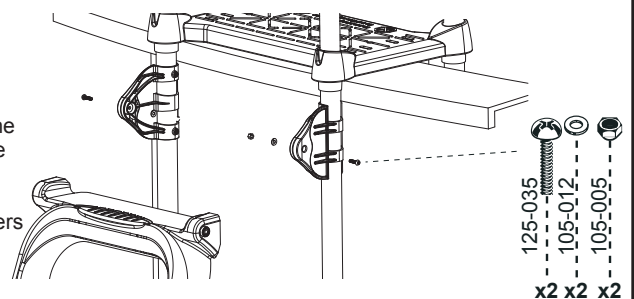

# H

CABLE LOCK x1  
\*\*\*PADLOCK REQUIRED

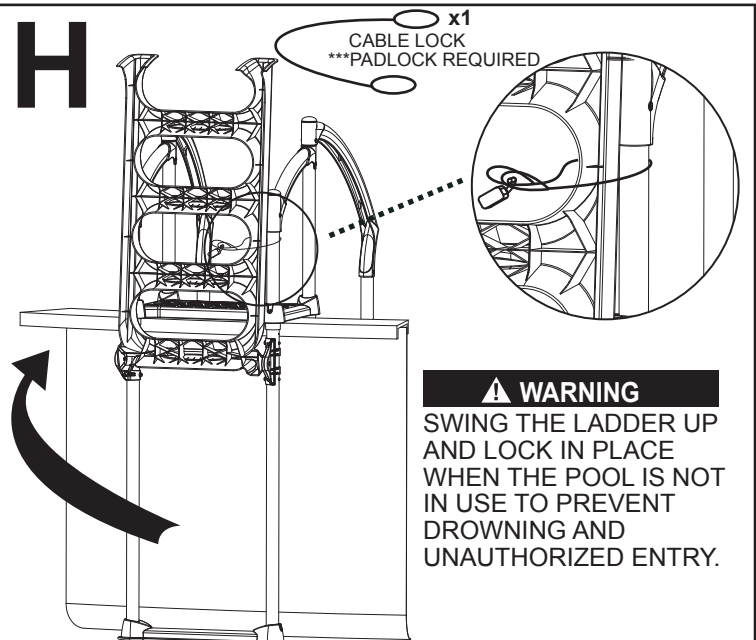

**⚠ WARNING**  
SWING THE LADDER UP AND LOCK IN PLACE WHEN THE POOL IS NOT IN USE TO PREVENT DROWNING AND UNAUTHORIZED ENTRY.

**InnovaPlas**  
The pool Step Company

370 Lajeunesse St.  
St-Jérôme (Québec),  
Canada J7Y4E5



## MANUFACTURER WARRANTY

1 Year on the Classic ladder and Biltmor.  
1 year on the hardware.